



WORLDWIDE ELECTRIC MOTOR DATA SHEET



TJ13-36-56JB

HP	1/3
RPM / POLES	3600 / 2
VOLTAGE / PHASE	115/208-230 V / 1
FRAME	56J
ENCLOSURE	TEFC
FREQUENCY	60 HZ
RATED SPEED	3450 RPM
FULL LOAD AMPS	6.2/3.4-3.1 A
DUTY CYCLE	CONTINUOUS
SERVICE FACTOR	1.15
INSULATION CLASS	F
BASE TYPE	C-FACE - REMOVABLE
SHAFT	THREADED
DE BEARING	6203
ODE BEARING	6203
MOUNTING	F1
ROTATION	CW
OVERLOAD	AUTOMATIC
START CAPACITOR	Ø42 x 80mm ² / 200uF / 125V
RUN CAPACITOR	---
WIRE TYPE	LOOSE WIRE
WIRE HOUSING	JUNCTION BOX
CONNECTION DIAGRAM	115/208-230 V - 6 LEAD
APPROX. WEIGHT	23 LBS.
FL EFFICIENCY	58.0%





WORLDWIDE ELECTRIC MOTOR DRAWING
TJ13-36-56JB

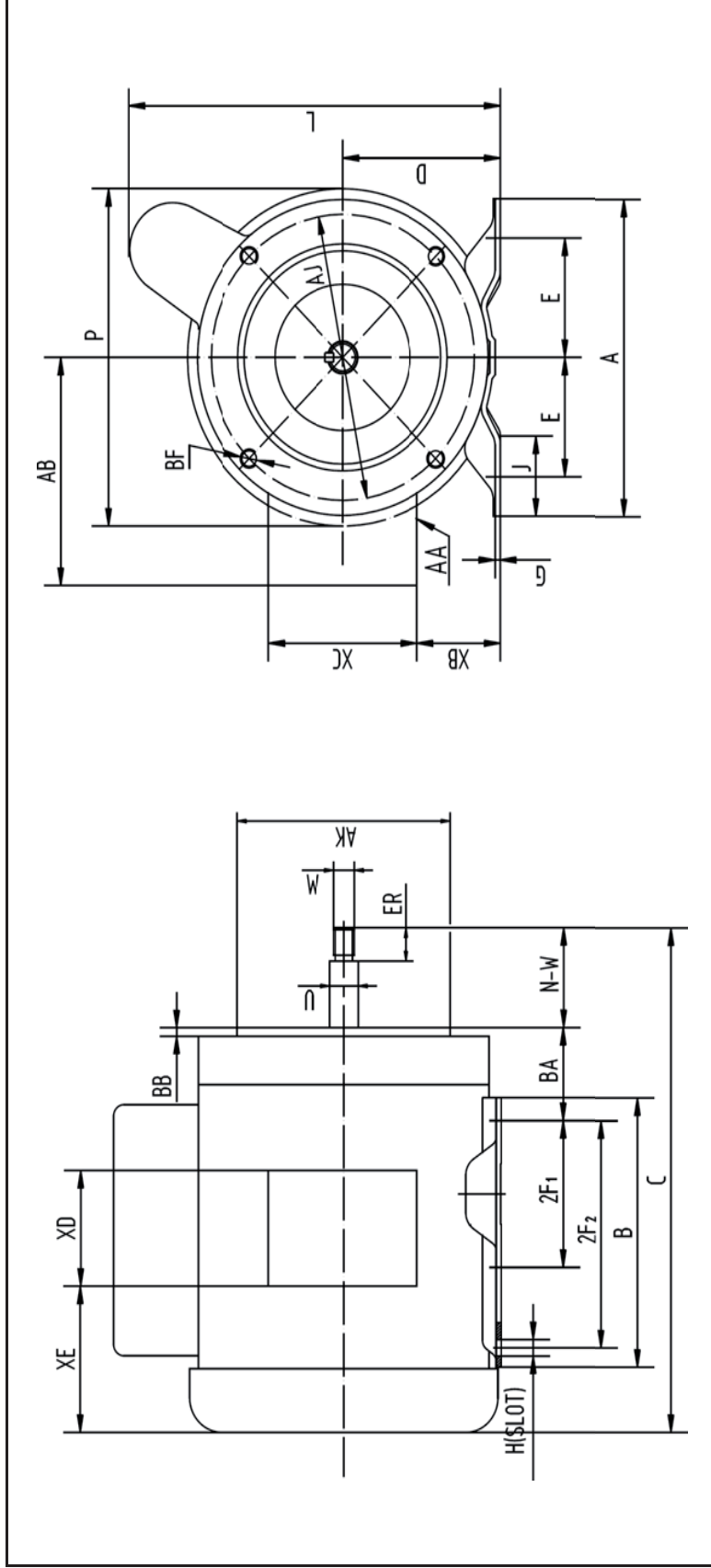

MOUNTING			
E	2F1	2F2	H
2.44	3	5	0.34

A	B	C	D	G	J	L	P	AA
6.5	6.5	12.6	3.5	0.12	1.73	8.07	6.9	1/2

FLANGE				SHAFT				TERMINAL BOX				
AB	AJ	AK	BB	BF	ER	M	N-W	U	XB	XC	XD	XE
5.35	5.875	4.5	0.16	3/8-16	0.68	7/16-20	2.4	0.625	1.65	3.7	3.23	2.85

ALL DIMENSIONS IN INCHES